

JOHN FUHRER DOWNTOWN HELISTOP

DT1 | N 26° 7.23' | W 80° 8.52'

201 S.E. 2ND AVE., 6TH LEVEL (CITY PARKING GARAGE) | FORT LAUDERDALE, FL 33301

FOR RESERVATIONS OR ASSISTANCE: (954) 968-9675 | FAX: (954) 938-4974

UNICOM: 123.05 MHZ | FLL TOWER: 119.30 MHZ (CLASS C AIRSPACE)

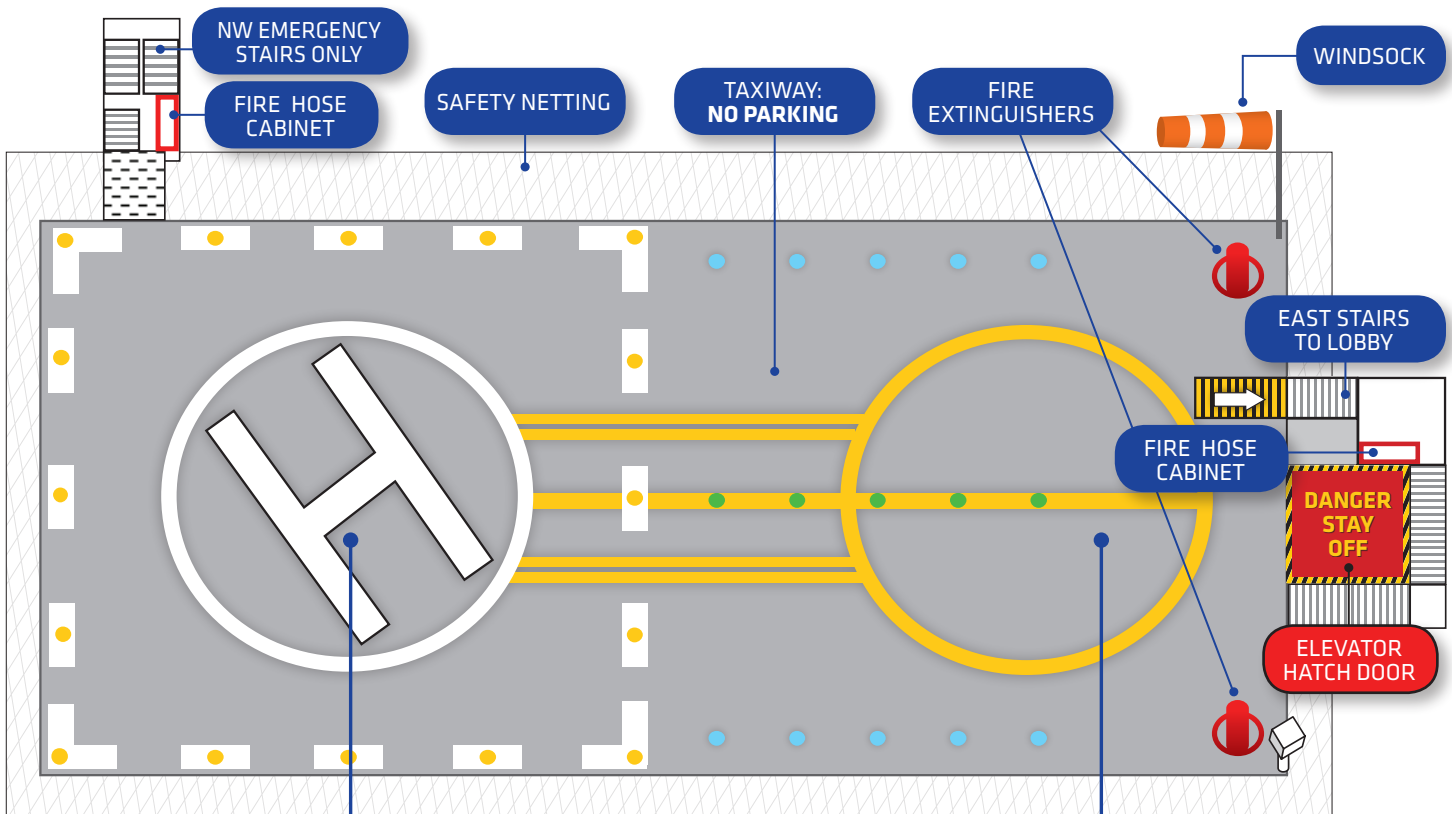

LANDING POSITION (84' X 84') / FATO:

- 11,900 lbs. maximum gross weight
- 46 feet maximum main rotor diameter
- 114 feet AGL deck elevation
- One helicopter only
- Open 24-hours
- Deck lighting: dusk to dawn
- Engine shutdown prohibited. NO PARKING
- For assistance call anytime (954) 968-9675.

HELICOPTER PARKING POSITION:

- Reservations required at all times. Call the Helistop at (954) 968-9675 to receive approved parking times and access instructions.
- One helicopter only.
- No landings or takeoffs from this position.
- No landing or helicopter parking fee.
- For assistance call anytime (954) 968-9675.
- Vehicle parking permits available.